



Cloud User Manual



2CH QHD G-NET DASH CAM

## Quick User Guide rev01

This manual includes the basic information required in order to set up and operate the G-ONQ. For more details including all other official user manuals for G-ONQ product, please visit the GNET SYSTEM's website at: <https://www.gnetsystem.com/eng> → SUPPORT → DOWNLOAD

## IMPORTANT SAFETY INSTRUCTIONS WARNING

© 2022 GNET SYSTEM CO.,LTD. or its subsidiaries All rights reserved. Under the copyright laws, this manual may not be copied, in whole or in part, without the written consent of GNET SYSTEM CO.,LTD. GNET SYSTEM CO.,LTD reserves the right to change or improve its products and to make changes in the content of this manual without obligation to notify any person or organization of such changes or improvements. Go to [www.gnetsystem.com](http://www.gnetsystem.com) for current updates and supplemental information concerning the use of this product.

GNET® and the GNET logo, are trademarks of GNET SYSTEM CO.,LTD. or its subsidiaries, registered in South Korea and other countries. GNET G-ONQ, are trademarks of GNET SYSTEM CO.,LTD. or its subsidiaries. These trademarks may not be used without the express permission of GNET.

microSD® and the microSD logo are trademarks of SD-3C, LLC. Wi-Fi® is a registered mark of Wi-Fi Alliance Corporation.

- Do not expose the unit to electrical shock or debris.
  - This may cause product damage, fire, or electrical shock.
- Avoid use with excessive vehicle window tints or special auto glass.
  - Images may be blurry or distorted and may cause interference with the reception rate of the GPS.
- Do not modify or dismantle the device/ accessories.
  - We are not responsible for any damage to the device or vehicle due to user tampering.
- Never operate the device or adjust settings while driving.
  - Always keep your eyes on the road.
- Do not use liquids or chemicals to clean the product or accessories.
  - This may cause product damage, fire, or electrical shock.
- Please use a non-scratch lens cloth to clean the product and accessories.
  - Routinely clean camera lens for best results.
- In the absence of the external GPS, the device's date and time may be reset.
  - Please always check that the date/ time is correct.
- When parked for long periods of time in direct sunlight, a temperature increase inside the vehicle may result in a memory card corruption and/ or recognition error.
  - It is recommended to remove the memory card and store it out of direct sunlight during long periods of vehicle inactivity.
- Avoid high temperature or high humidity environment for normal operation of the product.
- Check the operation of the interior camera(S) periodically before driving.
  - Only the front camera will be captured in the event of a malfunction or defect.

## CAUTION FOR MEMORY CARD

- Overtime, memory degradation can occur and should be replaced periodically.
- To prevent incompatibility problems, please use only a genuine GNET memory card. The GNET memory cards are specifically designed to operate with our GNET systems and are covered under our warranty program.
- When a vehicle accident occurred, it is recommended to remove the memory card from the device and save the data to a computer immediately. When the memory card is full, the data will be overwritten, and the accident data will be lost.
- Please be sure to remove the memory card only after the recording LED is off. Otherwise, if removed too early, video data could be lost or corrupted. This can also shorten the card's lifespan.
- Please do not interchange / swap the memory cards between other products. Data may be erased and lost if the memory card is automatically formatted.
- It is recommended that the memory card be formatted at least twice a month for product and lifespan maintenance. For best results, please use the official SD Formatter ([www.sdcard.org](http://www.sdcard.org)).
- GNET System dash cameras can support memory card (SD) capacities ranging from 32GB to 256GB.
- When a new or used memory card is inserted into the device for the first time, the system will go into standby mode for 3 to 5 minutes. Please do not attempt to remove the memory card during standby mode or when the device is formatting the card.
- It is possible to format the memory card in the GNET application for Mac and PC. Please visit the GNET SYSTEM's website at:  
<https://www.gnetsystem.com/eng> → SUPPORT → DOWNLOAD

# PRODUCT COMPONENTS

## Basic Components



Main Camera



Rear Camera



Hardwire Kit



Screw, Wrench



Micro SD  
Memory card



Rear Camera  
connection cable



Wi-Fi dongle



External GPS



User Manual

---

## Optional Product



Cigarette lighter power cable



OBD power cable

**!** Cigarette lighter and OBD power cables are each sold separately.

- ※ The size and appearance of the components depicted above may be different from the real components.
- ※ Specifications and components may be changed without notice for quality assurance.
- ※ We highly recommend that a GNET Genuine Memory Card be used with all GNET products.

## NAME OF EACH PART

### Front camera

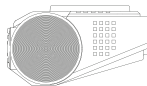
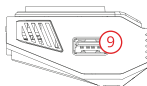
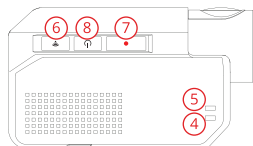
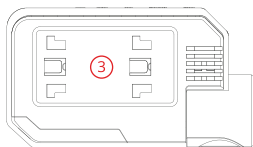
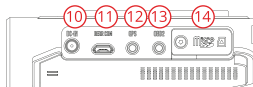
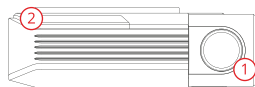

① Front Camera Lens

② Security LED

③ Front cam bracket

④ GPS LED

⑤ REC LED

⑥ Wi-Fi Connection button

⑦ Manual recording button

⑧ Power button

⑨ Wi-Fi USB dongle port

⑩ Power connector port (DC-IN)

⑪ Rear Camera Slot

⑫ GPS connector port

⑬ OBD2 Connector

⑭ Micro SD card Slot

### Rear Camera

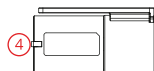
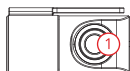

① Camera lens

② Rear cam mount

③ Rear cam connector port

④ Status LED

## SPECIFICATIONS

Image Sensor	SONY STARVIS
Audio input	Built-in Microphone
Video Compression	H.265
Audio Compression	ADPCM
Resolution	Front : QHD (2560 X 1440), Rear : QHD (2560 X 1440)
Frame Rate	All cameras : Max. 30 FPS
Recording Time(Approx.)	32GB : 2 hrs 40 mins / 64GB : 5 hrs 30 mins / 128GB : 11hrs / 256GB : 22hrs
3G/4G/Router (Optional)	Connect to withCLOUD via 3G/ 4G/ Router telecommunication
Wi-Fi (Optional)	Connect to GNET Smart phone application via Wi-fi dongle
G-Sensor	Event recording by External Shock
Speaker	Operation Status alarm / Voice guidance
External GPS	Synched with Google map, Keep track of location and Speed
Angle Of View	Front: 140°, Rear: 140°
Viewer	Windows 7/8/10, Mac, Support 32Bit/ 64Bit, Synchronizing Google map with PC viewer is supported for Windows7 and explorer 10 as per Google's policy.
Power	DC 12V - 24V
Allowable current of providing fuse	3A
Operation Temperature	-20℃ ~ 70℃
Humidity	10~95%
Dimension (WxHxD, mm)	Front: 116x56x32, Rear: 44x38x28

※ Specifications and components are subject to change without notice for quality assurance.

# INSTALLATION

## Inserting the Memory card

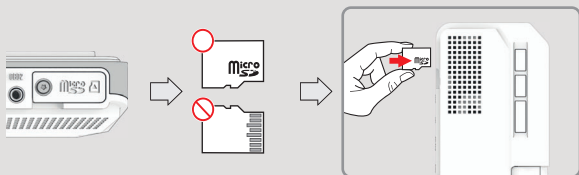

## HOW TO INSTALL DASHCAM

- 1 Assemble the front camera with the provided bracket in the order displayed. Make sure the bracket is hooked correctly. Push and align it until it clicks in.

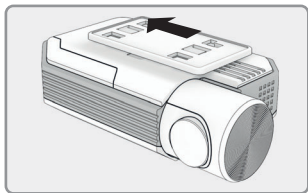

- 2 Insert the memory card into the memory card slot, and then remove the backing sticker from the adhesive pad.

- 3 Adhere the front camera on the front windscreen as close to the rear vision mirror as possible. Ensure there is enough space to access cables and the SD card. Install the rear camera as close to the top centre of the rear windscreen as possible.

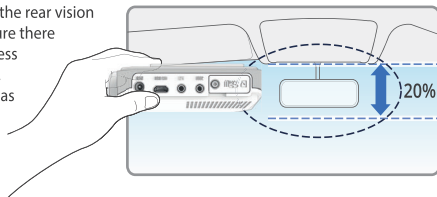

- 4 Connect direct power cable to the fuse box in the vehicle and connect the power cable and rear camera cable.

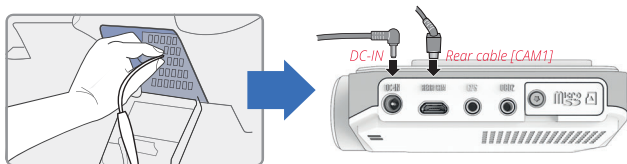

- 5 Install the rear camera to the rear windshields of the car.

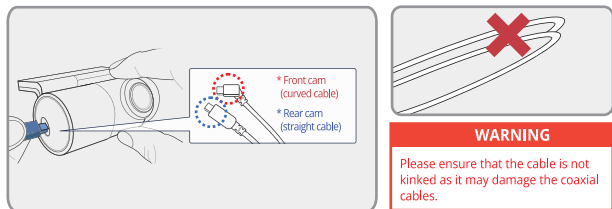

- 6 Carefully fasten the front and rear power cables onto the linings of the vehicle ceiling and windscreen. Caution: Ensure cables are not restricting airbag deployment.

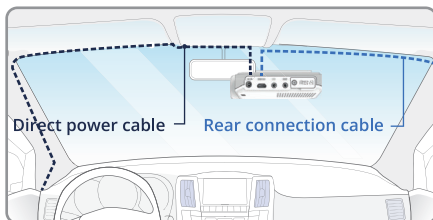



## SD CARD SECURE COVER

- 1 Open the SD card cover and insert the memory card.

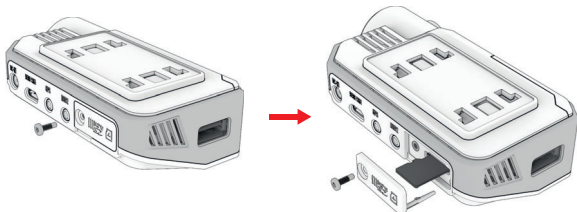

- 2 Then slide the SD cover into the hole as shown, and fasten the screw to the body.

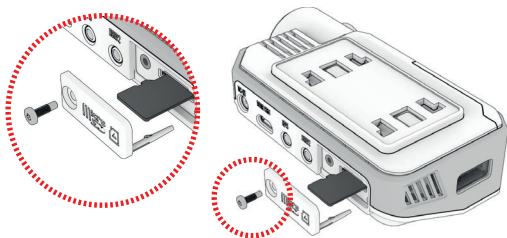

- 3 Covering the SD card is completed.

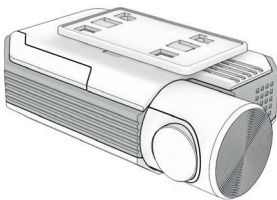

## Become a Cloud member

<http://cloud.gnetsystem.com>

- 1 Please access LINK and click the "Sign up" button.

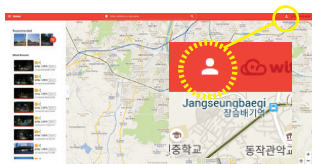

- 2 Fill in your information and proceed by clicking the "Sign up" button.

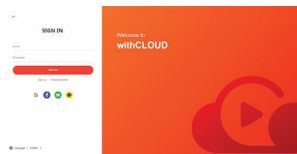

## Enroll your Vehicle/ Dash cam information

- 1 When you login to the cloud server for the first time, click the "My Vehicles" button from the menu.

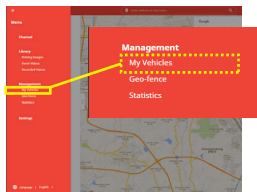

- 2 Click the + Add a Vehicle button and enroll the vehicle/ Dash cam information



- 3 After you fill in your information, make sure to insert the serial number from your dash camera device.

The dash camera serial is displayed on the front camera label.

Once the vehicle registration is complete, the data of your dash camera will now be stored in the cloud servers automatically.

**Add a Vehicle**

Plate No.

Group Name

Vehicle Model

Driver Name

Serial Number

OK CANCEL

## WI-FI POWER ON/OFF

### Wi-Fi Power On

The Wi-Fi power will be on when you press the power button for two times or press Wi-Fi button for 1 time.

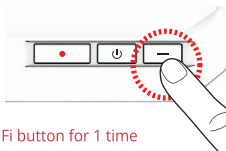

### Wi-Fi Power OFF

The Wi-Fi power will be off when you press the power button for two times.

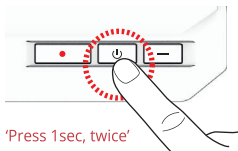

## POWER ON/OFF

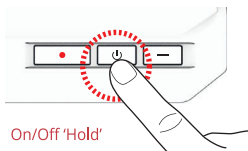

Press the power button to turn the system off. To restart the system, press and hold the power button.

## CHANGE INTO WI-FI OR CLOUD MODE

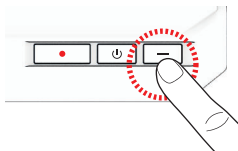

The Wi-Fi mode is changed to the CLOUD mode or the CLOUD mode is changed to the Wi-Fi mode if you press the Wi-Fi button for 3~4 seconds.

(At this time, when switching to the Wi-Fi mode or the CLOUD mode, dash cam is on and does not reboot)

# PLAYER MENU NAME



## ① Tool Box

- Save
- Open Folder
- Print
- Setting

## ② Google Map

When GPS and internet are connected, it will work normally.

## ③ Playlists and Information Display

## ④ GPS reception window

It can be used only when an external GPS is connected.

## ⑤ Video control popup

- Thumbnail
- Draw a lane
- View a video
- Split View
- PIP View
- Toggle (change) color, black and white mode

## ⑥ G-sensor (acceleration) graph

## ⑦ Speedometer

It can be used only when an external GPS is connected

## ⑧ Play a recorded video

- forward play
- Pause
- Repeat event video
- Previous, Next Event
- play frame by frame

## ⑨ Adjust playback speed ⑩ Sound control

## How to check G-sensor data

<Magnification of G-sensor data>

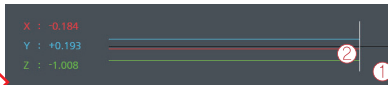

① The location of the image currently being played

② Numerical values and graphs of three-dimensional coordinate system information (G-sensor data)

- When you play the video, three-dimensional coordinate system information (G-sensor data) on the X-axis (progress direction), Y-axis (left-right), and Z-axis (height) of the image currently being played at the G-sensor data location is output.

# SMARTPHONE CONNECTION

## How to connect an Android smartphone

- 1 Install the GNET application on the smartphone.  
\* G-net application is not available while cloud mode is on.



- 2 Press the Wi-Fi® button on the dash camera to enter standby mode with the voice message "Registration standby mode" (last 2 minutes)

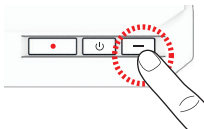

- 3 Touch the "+" to search for your device - use the left and right arrows scroll. Once your device has been located select the "Connect" button.

[★] will indicate first time connection to the device.

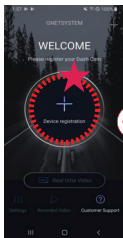

- 4 The registration of the dash camera is completed when you hear "User's connected".

\* If the connection fails due to a weak Wi-Fi signal, please carefully unplug and immediately re-insert the Wi-Fi dongle back into the camera. Proceed to try the connection again by pressing the Wi-Fi button to enter standby mode.

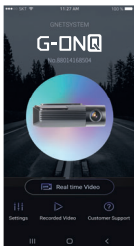

## How to connect an Apple iOS smartphone

- 1 Install the GNET application on the smartphone.  
\* G-net application is not available while cloud mode is on.



- 2 Press the Wi-Fi\* button on the dash camera to enter standby mode with the voice message "Registration standby mode" (last 2 minutes)

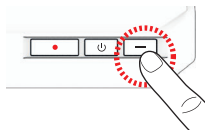

- 3 Enter the Settings menu and proceed to locate and connect to the dash camera's Wi-Fi network (begins with GNET\_BB\_).



The password is as follows: **qwertyuiop**

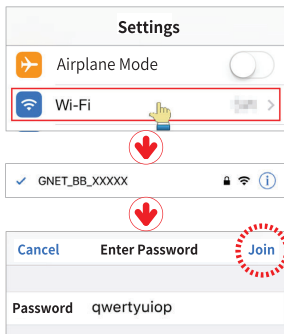

- 4 The registration of the dash camera is completed when you hear "User's connected".

\* If the connection fails due to a weak Wi-Fi signal, please carefully unplug and immediately re-insert the Wi-Fi dongle back into the camera. Proceed to try the connection again by pressing the Wi-Fi button to enter standby mode.

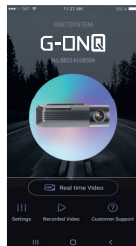

## GNET Smartphone App

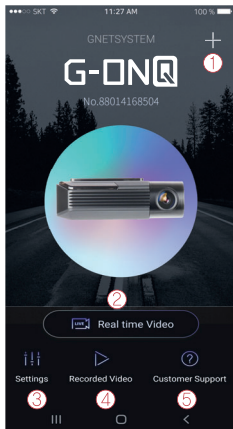

- ① This function allows you to connect other dash cams or delete the registered devices.  
※ Supported only on Android mobile
- ② Real-Time Video  
Select this button to view a live video feed from the dash camera.
- ③ Settings  
You can easily toggle camera settings via your smartphone. When finished, select the "Save" button to reboot the system.
- ④ Recorded Video  
View previously recorded video from the camera's SD card. Video can be downloaded directly onto the smartphone.
- ⑤ Customer Support  
Need product support? Select this button to be directed to our customer support center.

---

## Download our Smartphone App

Available for Android and Apple iOS. Search "GNET" on Google Play and Apple App Store.

Or simply scan our QR Code:



## Precaution Before Use

- Set the time zone on the GENT app or the viewer.
- Smartphone make, model, or specification can interfere and delay real time video playback.
- DO NOT operate the device or adjust App settings while driving.  
Please always safely pull over when interacting with GNET products.

## Warranty Card

Product	GNET Dash cam		Model	G-ONQ
Serial Number			Purchase Date	
Customer Information	Name		Tel	
	Address			
Seller/ Vendor			Tel	
Warranty Period	Dash Camera : 2 Year Micro SD card : 3 months			

\* If you require product repair, service and/or support,  
please contact your local seller or send us an email: [info@gnetsystem.com](mailto:info@gnetsystem.com)



[www.gnetsystem.com/eng](http://www.gnetsystem.com/eng)  
6F Lotte IT Castle II Gasan Digital 2ro 98,  
Geumcheon-gu, Seoul, Korea  
[info@gnetsystem.com](mailto:info@gnetsystem.com)

