





PARTS REQUIRED FOR INSTALLATION OF : MMCARFK5000

XTX-3000 	IVU-CAB-4W 	MMCAHCXMI1 (Sold Separately) 	
---	---	---	--

STEP 1. CONFIGURE THE REMOTE STARTER

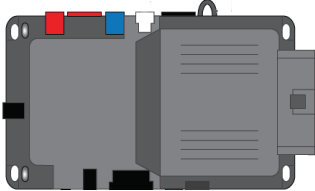
The ADS Weblink (ADS-USB) is required to properly configure the MMCAHCXMI1 remote starter to accept the MMCARFK5000 RF kit system. When flashing the MMCAHCXMI1 remote starter, please follow this procedure in order to configure correctly your remote starter.

a. Go to mitsubishi.idatalink.com and click on "Flash your starter"

Flash your starter

b. Choose vehicle Make, Year, Model, Trim.



c. In the "Telematics Device" section, Set the Switch to On and Choose "MYCAR".



d. This will load a firmware starting with:

"IDSI-XX(XX)-XXX (X.X)"

e. Click "Flash your device"

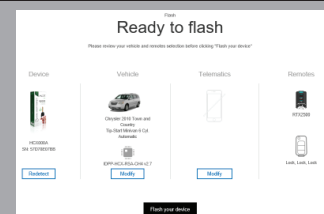

COMPLETE INSTALLATION MANUAL CAN BE FOUND ONLINE AT:

MITSUBISHI.AUTOMOB.CA



CONNECTED INSTALLATION, WIRING & PROGRAMMING GUIDE

STEP 2. CONNECT

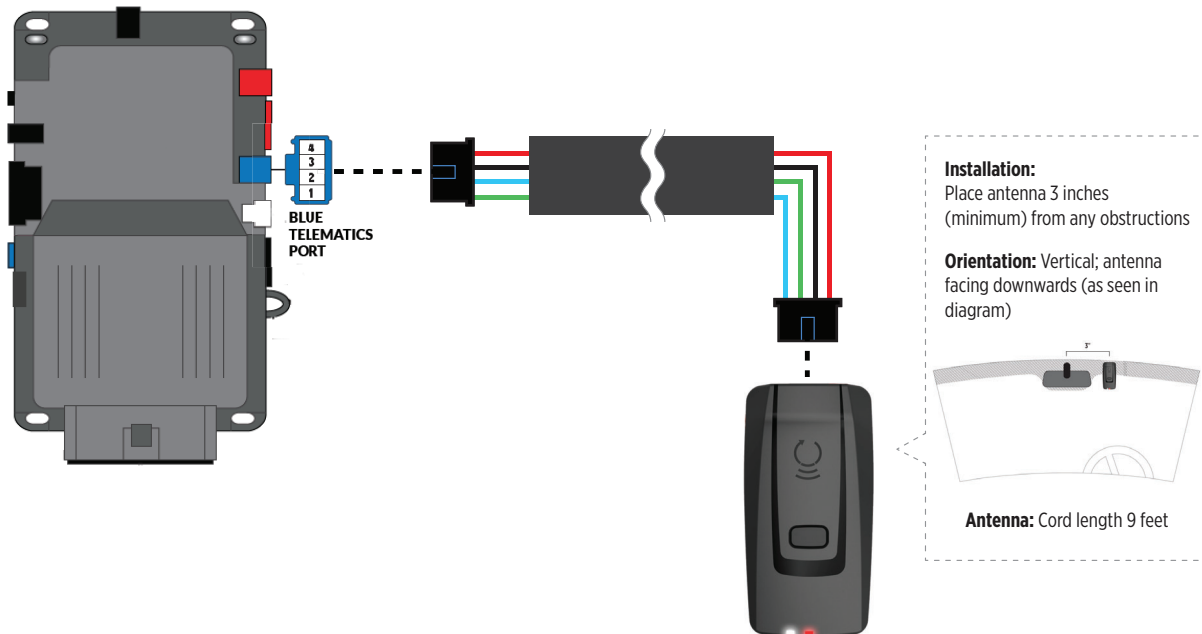

STEP 3. ADD A DEVICE/VEHICLE TO AN ACCOUNT

- Download the App and Log into your account.
- Click the "+" sign at the bottom right of the Application screen. This will allow you to temporarily add and configure your customer's system inside your personal account. A system refers to the Antenna being installed in the windshield of the vehicle.
- Before adding a system to your device, ensure the remote starter IS NOT armed/locked or in Valet mode and set the ignition of the vehicle to the On position.
- Then Tap to "Scan QR Code" and use the smartphone camera to scan the QR Code located on top of the antenna.
- Once connected for the first time, the system is in "Installer Mode". Follow the on-screen instructions for configuring the system.

STEP 4. PRE-CONFIGURE THE APPLICATION EXPERIENCE FOR YOUR CUSTOMER

- Start by setting the protocol of the antenna being used. This is achieved by selecting the Brand, Model and protocol used inside the Remote starter. When done, click on "Confirm". System will now try to communicate with the remote starter to confirm that all settings related to protocol are valid. Ensure to set as follow : **ADS / AL-CA / ADS TEL.**
- Once back in the control panel, click on the Settings Gear at the top right of the screen and edit the Vehicle name, configure the Auxiliaries that might have been added (if applicable) and click "OK" when done. Then choose the vehicle to display inside the control panel in the VEHICLE IMAGE section and click OK.
- When your configurations are all completed, click "OK" at the top right corner. All Configurations will take effect.

STEP 5. TESTING THE SYSTEM

When the system is connected and fully configured, testing can begin. Test all the application functions (Start, Stop, Lock, Unlock, Auxiliaries, Etc.) When testing is completed, tap on the "installer icon" at the top of control screen. When prompted Click "Yes, and delete system from account" since this is the installer mode and not the End User mode. This will make the system "Ready for Customer Delivery".

Also make sure that the Owner's Card is handed to the Owner of the vehicle or attached to the vehicle keychain. Doing this will ensure that the instructions on how to setup their App, Account and add the System is done correctly by using the system QR Code affixed on the windshield mounted antenna.

NOTE : UNDER ANY CIRCUMSTANCES, PLEASE DO NOT REMOVE THE QR CODE FROM THE ANTENNA!